

OUTSIDE CORNER DETAIL	3	SERVICE COUNTER ISOMETRIC	2
Scale= 3" = 1'-0"	A-104	Scale= 3/4" = 1'-0"	A-104

TILE SCHEDULE							
INSTALLED AND FURNISHED BY: G.C. UNLESS NOTED OTHERWISE							
NO.	MANUFACTURER	DESCRIPTION	COLOR	FINISH	JOINT	GROUT	REMARK
(T-108)	CMC AGGREGATE DOUG SALATINO 518-713-5371	12" X 24" X 3/8"	-	-	1 / 8"	G-111	RESTROOM WALL
(T-111)	DALTILE	6" X 36" X 3/8" 9" X 36" X 3/8"	FOREST PARK - SUMMERTREE FP95	MATTE	1/8"	G-115	RR VESTIBULE & DINING ROOM WALLS CONTACT: NATIONAL ACCOUNT SUPPORT DESK 877.556.5728 (national.accounts@daltile.com)
(T-124)	CMC DOUG SALATINO 518-713-5371	24" X 24"	MARQUSETTE CALACATTA BLACK	MATTE	1/8"	G-116	DINING WAINSCOT
(T-200)	CMC DOUG SALATINO 518-713-5371	24" X 24"	BRAVADA GREIGE	MATTE	1/8"	G-96	DINING & RESTROOM FLOOR
(T-300)	DALTILE	13.562" SQUARE REVALIA BASE REMIX-FAN	FELICITY WHITE	GLOSSY	1/8"	G-114	BEVERAGE COUNTER BACKSPASH AND SERVICE COUNTER
(T-402)	CMC DOUG SALATINO 518-713-5371	8" HEXAGON ROUNABOUT	GREY	MATTE	1/8"	G-107	DINING ROOM FEATURE AREA
(S1)	SILIKAL	QUARTZ BLEND #4	-	PLAIN	-	-	KITCHEN, SERVICE FLOOR CONTACT: MARK FELDMAN 770-830-1404 (mfeldman@silikalamerica.com)
(S2)	SILIKAL	QUARTZ BLEND #4	-	ABRASIVE	-	-	JOHN COTHAN 888-830-1404 (jcothran@silikalamerica.com)
GROUT							
NO.	MANUFACTURER	DESCRIPTION	MFG.	COLOR	FINISH	REMARK	
(G-96)	MAPEI 800.42.MAPEI WWW.MAPEI.COM	LATEX MODIFIED GROUT	11	SAHARA BEIGE	POLY BLEND 1 / 8" NON-SANDED	DINING & RESTROOM FLOOR APPLY GROUT SEALER	
(G-107)	MAPEI 800.42.MAPEI WWW.MAPEI.COM	LATEX MODIFIED GROUT	107	IRON	POLY BLEND 1 / 8" NON-SANDED	DINING ROOM FLOOR APPLY GROUT SEALER	
(G-111)	MAPEI 800.42.MAPEI WWW.MAPEI.COM	LATEX MODIFIED GROUT	19	PEARL GREY	POLY BLEND 1 / 8" NON-SANDED	RESTROOM, DINING APPLY GROUT SEALER	
(G-113)	MAPEI 800.42.MAPEI WWW.MAPEI.COM	LATEX MODIFIED GROUT	07	CHOCOLATE	POLY BLEND 1 / 8" NON-SANDED	APPLY GROUT SEALER	
(G-114)	MAPEI 800.42.MAPEI WWW.MAPEI.COM	LATEX MODIFIED GROUT	19	PEARL GREY	POLY BLEND 1 / 8" NON-SANDED	BEVERAGE COUNTER BACKSPASH APPLY GROUT SEALER	
(G-115)	MAPEI 800.42.MAPEI WWW.MAPEI.COM	LATEX MODIFIED GROUT	42	MOCHA	POLY BLEND 1 / 8" NON-SANDED	APPLY GROUT SEALER	
(G-116)	MAPEI 800.42.MAPEI WWW.MAPEI.COM	LATEX MODIFIED GROUT	10	BLACK	POLY BLEND 1 / 8" NON-SANDED	DINING WAINSCOT APPLY GROUT SEALER	

* REFER A-200 EXTERIOR FINISH SCHEDULE FOR EXTERIOR DECORATIVE TILE	
* SCHLUTER SYSTEM ALUMINUM TRIM:	
COVE TILE TRIM: INSTALLED AT RESTROOM, SERVICE COUNTER, AND DRINK STATION SCHLUTER SYSTEMS DILEX-AHK 1S 125 ATGB (BRUSHED NICKEL ANODIZED ALUMINUM) -OUTSIDE CORNER CONNECTOR PIECE: DILEX-AHK-E90/AHK 1S 125 ATGB (BRUSHED NICKEL ANODIZED ALUMINUM) -INSIDE CORNER CONNECTOR PIECE: DILEX-AHK-190/AHK 1S 125 ATGB (BRUSHED NICKEL ANODIZED ALUMINUM) -END CAP PIECE: DILEX-AHK-E/AHK 1S 125 ATGB (BRUSHED NICKEL ANODIZED ALUMINUM)	
(TR100)	
EDGE TILE TRIM: SCHLUTER SYSTEMS RONDEC-RO125 AMGB (BRUSHED BRASS ANODIZED ALUMINUM) -OUTSIDE CORNER CONNECTOR PIECE: RONDEC-EV/RO125 AMGB (BRUSHED BRASS ANODIZED ALUMINUM) -INSIDE CORNER CONNECTOR PIECE: RONDEC-12L/RO125 AMGB (BRUSHED BRASS ANODIZED ALUMINUM)	
(TR101)	
EDGE TILE TRIM: INSTALLED AT SERVICE COUNTER TOE KICK SCHLUTER SYSTEMS JOLLY-A 80 AMGB (BRUSHED BRASS ANODIZED ALUMINUM) -OUTSIDE EDGE PROTECTION PIECE	
(TR103)	
EDGE TILE TRIM: INSTALLED AT FLOOR INLAY SCHLUTER SYSTEMS SHIENE-R/M 125 (SATIN BRASS ANODIZED ALUMINUM)	
(TR104)	
* EPOXY GROUT BY MAPEI, KERAPOXY IEG, 100% SOLIDS INDUSTRIAL GRADE: AREAS: UNDER HOOD AND 36" IN FRONT OF COOKING LINE, 3 COMPARTMENT SINK AND MOP SINK AREA SEE MANUFACTURER'S SPECIFICATION, DETAILS AND GUIDE FOR PREPARATION, MIXING, GROUTING AND CLEANING INSTRUCTION NOTE: SEE INTERIOR SHEETS FOR WALL/ BASE TILE LOCATIONS AND SPECIFICATIONS	

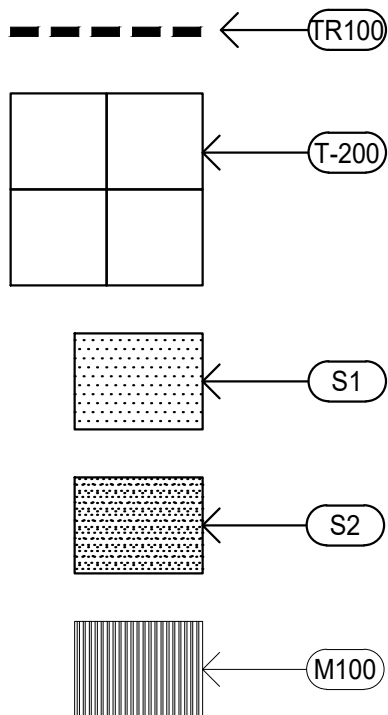

FINISH SCHEDULE	A
Scale= NTS	A-104

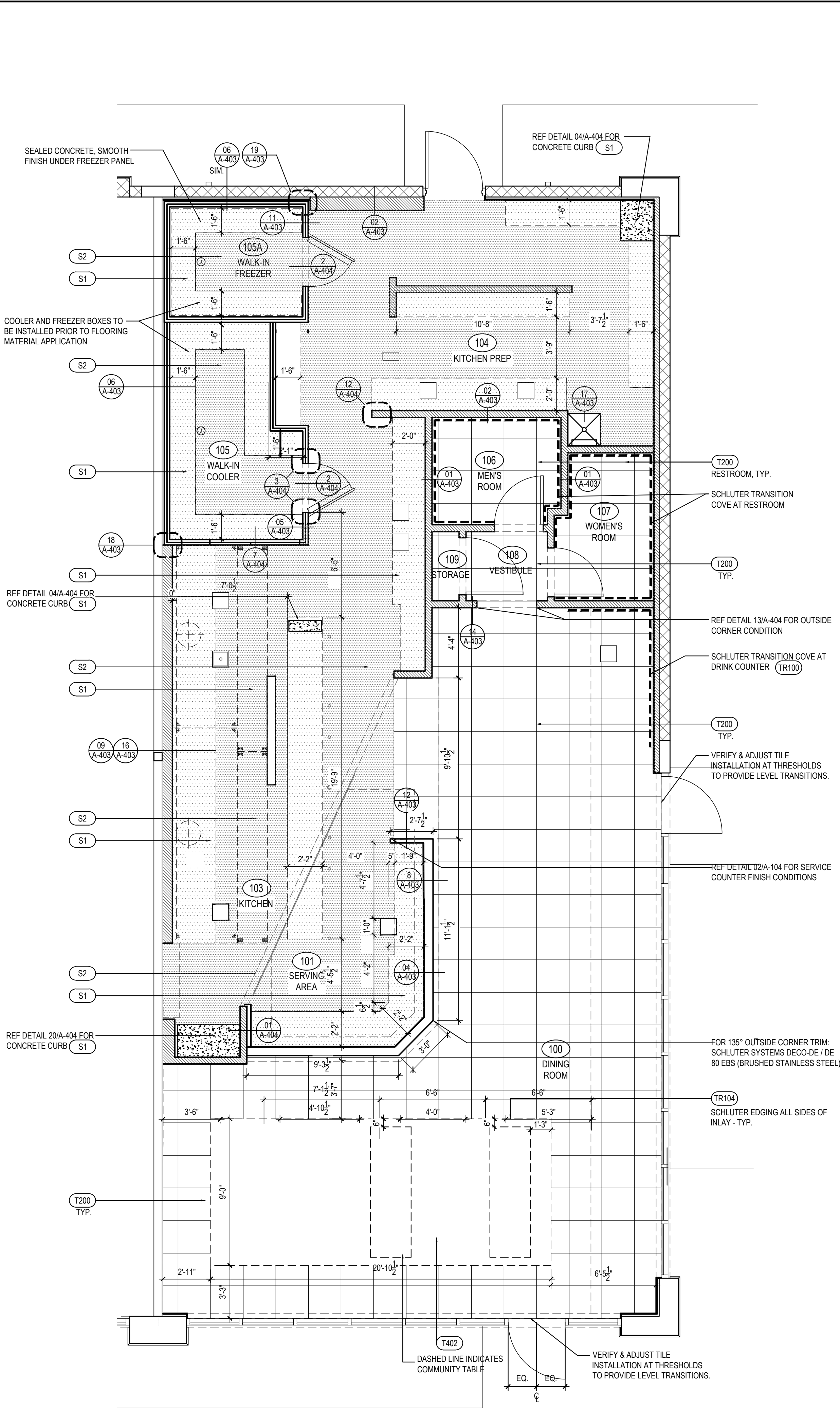

FINISH PLAN	1
Scale= 1/4" = 1'-0"	A-104

PANDA EXPRESS, INC.
1683 Walnut Grove Ave.
Rosemead, California 91770
Telephone: 626.799.9898
Facsimile: 626.372.8288

All ideas, designs, arrangement and plans indicated or represented by this drawing are the property of Panda Express Inc. and were created for use on this specific project. None of these ideas, designs, arrangements or plans may be used by or disclosed to any person, firm, or corporation without the written permission of Panda Express Inc.

REVISIONS:

ISSUE DATE:

1	BID SET	2023-05-02

DRAWN BY: / JAD

PANDA PROJECT #: S4-24-D22020
ARCH PROJECT #: P7377

Plans Prepared By
Cph, LLC
500 West Fulton St.
Sanford, FL 32771
Ph: 407.322.6841
Licenses:
Eng. C.O.A. No. 3215
Survey L.B. No. 7143
Arch. Lic. No. AA2600926
Lndscp. Lic. No. LC0000298

PANDA EXPRESS

PANDA END CAP
3301 W HILLSBORO BLVD
DEERFIELD BEACH, FL 33442

A-104

FINISH PLAN AND SCHEDULE

PANDA HOME 2600 R4/DAB